

PLEASE CHECK WWW.MOLEX.COM FOR LATEST PART INFORMATION

Part Number: [0495470392](#)
Status: **Active**
Description: 1.78mm (.070") Tab, 8.50mm (.335") Pitch Wire-to-Wire Female Housing TPA™, 3 Circuits, Vertical, Upper Type

Documents:

[Drawing \(PDF\)](#) [RoHS Certificate of Compliance \(PDF\)](#)

General

| | |
|----------------|---------------------------|
| Product Family | Accessories |
| Series | 49547 |
| Component Type | Retainer |
| Product Name | TPA™ - Term Pos Assurance |

Physical

| | |
|-------------------------------|-----------------|
| Circuits (Loaded) | 3 |
| Lock to Mating Part | Yes |
| Number of Rows | 1 |
| Packaging Type | Bag |
| Temperature Range - Operating | -40°C to +120°C |

Material Info

Reference - Drawing Numbers

| | |
|---------------|--------------|
| Sales Drawing | SD-49547-001 |
|---------------|--------------|

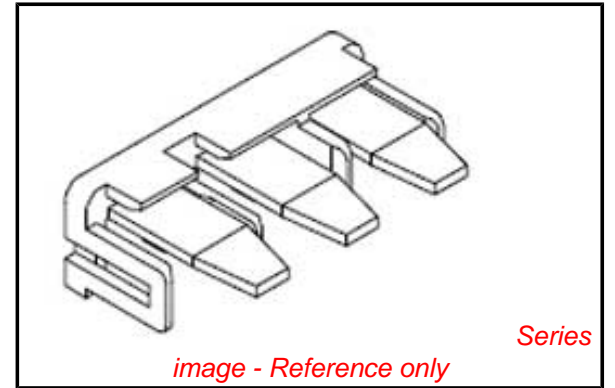

EU RoHS

ELV and RoHS Compliant
REACH SVHC
Contains SVHC: No
Halogen-Free
Status

China RoHS



Need more information on product environmental compliance?

Email productcompliance@molex.com
 For a multiple part number RoHS Certificate of Compliance, [click here](#)

Please visit the [Contact Us](#) section for any non-product compliance questions.

Search Parts in this Series

[49547Series](#)

Use With

[35965](#) Wire-to-Wire Female Housing

DWG. NO.
SD-49547-001

SIMILAR ITEM

PROJECT NO.

B

DO NOT SCALE DRAWING
DIMENSION IN METRIC

8 7 6 5 4 3 2 1

F

E

D

C

B

A

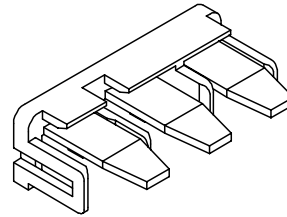
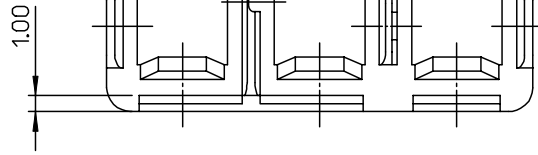

UPPER TYPE

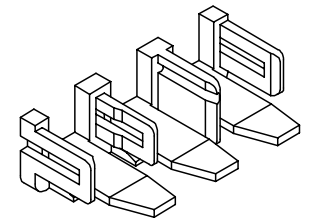

LOWER TYPE

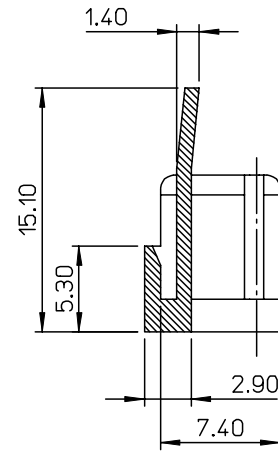
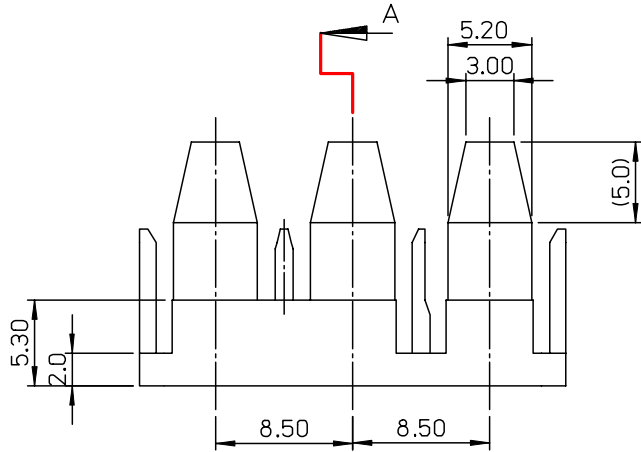
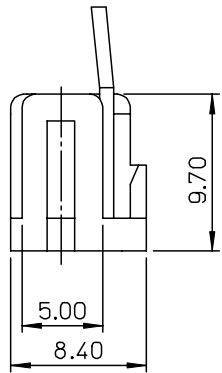

SECTION A-A

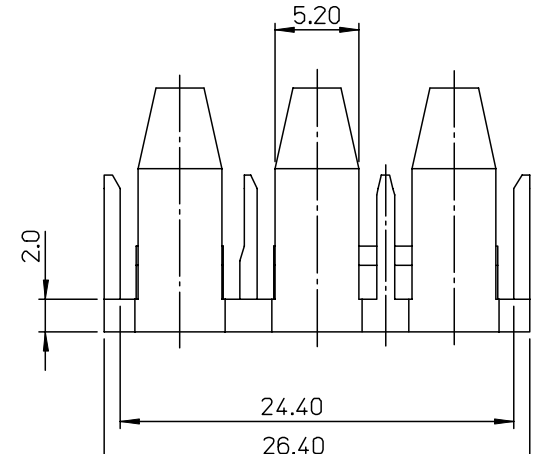

TRADE MARK
(MK1)

CAVITY NO.
(1,2,3,...)

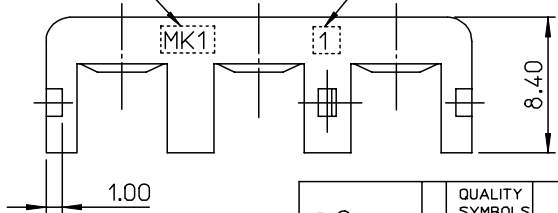

| NO. | DESCRIPTION | MATERIAL NO. | PART NO. | FINISH |
|-----|-------------|--------------|------------|---------------|
| 1 | UPPER TPA | 495470392 | 49547-0392 | RED COLOR |
| 2 | LOWER TPA | 495480390 | 49548-0390 | NATURAL COLOR |

NOTES

- MATERIAL : POLYAMIDE,UL94V-2
- MATED HOUSING : 35965-02**

| | | | | | | | | | | | | | | | | | | | | | | | | |
|---|---|--|---------------------------|--|------------------------|--|------------|-----------------------|----|----------|-----|----|----------|-------|----|---------|-------|----|--|----|------|--|-------------------------------------|--|
| NEW RELEASED ECN NO:KOR2006-0100 DRWN: J.B.JIN 06/02/11 CHK: W.Y.YANG APPR: SH.CHOI | QUALITY SYMBOLS | GENERAL TOLERANCES: (UNLESS SPECIFIED) | SCALE 3.5:1 | DESIGN UNITS <input checked="" type="checkbox"/> mm <input type="checkbox"/> INCH | THIRD ANGLE PROJECTION | DIMENSIONS: <input type="checkbox"/> mm <input type="checkbox"/> INCH <input checked="" type="checkbox"/> mm ONLY | SHT REV | REVISE ON CAD ONLY | | | | | | | | | | | | | | | | |
| | MAJOR = 0 CRITICAL = 0 | <table border="1"> <tr> <td>4 PLACES</td> <td>±0.</td> <td>±-</td> </tr> <tr> <td>3 PLACES</td> <td>±0.</td> <td>±-</td> </tr> <tr> <td>2 PLACES</td> <td>±0.20</td> <td>±-</td> </tr> <tr> <td>1 PLACE</td> <td>±0.30</td> <td>±-</td> </tr> </table> | 4 PLACES | ±0. | | | | | ±- | 3 PLACES | ±0. | ±- | 2 PLACES | ±0.20 | ±- | 1 PLACE | ±0.30 | ±- | <table border="1"> <tr> <td>mm</td> <td>INCH</td> </tr> </table> | mm | INCH | <table border="1"> <tr> <td colspan="2">DRAWN BY & DATE J.B.JIN 05/11/18</td> </tr> <tr> <td colspan="2">CHECKED BY & DATE W.Y.YANG 05/11/18</td> </tr> <tr> <td colspan="2">APPROVED BY & DATE SH.CHOI 05/11/18</td> </tr> </table> | DRAWN BY & DATE J.B.JIN 05/11/18 | |
| 4 PLACES | ±0. | ±- | | | | | | | | | | | | | | | | | | | | | | |
| 3 PLACES | ±0. | ±- | | | | | | | | | | | | | | | | | | | | | | |
| 2 PLACES | ±0.20 | ±- | | | | | | | | | | | | | | | | | | | | | | |
| 1 PLACE | ±0.30 | ±- | | | | | | | | | | | | | | | | | | | | | | |
| mm | INCH | | | | | | | | | | | | | | | | | | | | | | | |
| DRAWN BY & DATE J.B.JIN 05/11/18 | | | | | | | | | | | | | | | | | | | | | | | | |
| CHECKED BY & DATE W.Y.YANG 05/11/18 | | | | | | | | | | | | | | | | | | | | | | | | |
| APPROVED BY & DATE SH.CHOI 05/11/18 | | | | | | | | | | | | | | | | | | | | | | | | |
| DESCRIPTION | ANGULAR: ± 1 ° | CAD FILENAME S49547AA.MI | MATERIAL NO. SEE TABLE | DRAWING NO. SD-49547-001 | SHEET NO. 1 OF 1 | | | | | | | | | | | | | | | | | | | |
| REV | DRAFT WHERE APPLICABLE MUST REMAIN WITHIN DIMENSIONS | THIS DRAWING CONTAINS INFORMATION THAT IS PROPRIETARY TO MOLEX INCORPORATED AND SHOULD NOT BE USED WITHOUT WRITTEN PERMISSION. | | | SIZE B | | | | | | | | | | | | | | | | | | | |

MOLEX INCORPORATED